

# 2012

## Annual meeting of the Ornithological Society of Japan

---

September 14-17, 2012

Hongo Campus, University of Tokyo

## 2012 Annual meeting of OSJ

**Schedule:** September 14-17, 2012

	9:00	12:00	14:00	16:00	18:00	20:00
14th						Round table
15th	Oral sessions		Poster sessions	Oral sessions	Round table	
16th	General meeting	Celebration of 100th anniversary	Special lectures	Symposium	OSJ social gathering	
17th	Kuroda award lecture	Oral sessions	Poster sessions	Oral sessions	Round table	

### Campus of Agriculture and Life Sciences

**Ichijo hall of Yayoi auditorium:** Oral session A, Kuroda award lecture

**Lecture room 8 of building #1:** Oral session B

**Yayoi auditorium:** Poster session PA

**Yayoi auditorium annex:** Poster session PB

**Lecture rooms 4, 5, 6, 7, 9 and 10 of building #1:** Round table

**Meeting room of Department of Agricultural and Environment:**  
Round table

**Meeting room of Department of Ecosystem Studies:** Round table

**Meeting room of Yayoi auditorium:** Round table

### Yasuda auditorium

General meeting, the celebration of the 100th anniversary of OSJ, memorial lectures, memorial symposium

### Central refectory

OSJ social gathering

# Map of campus for Agriculture and Life Sciences

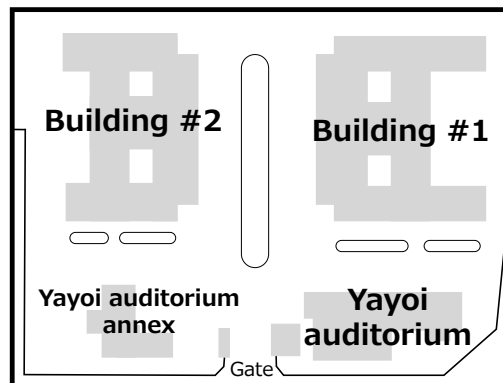
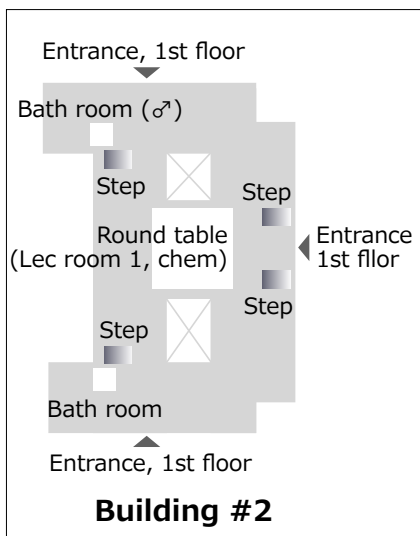
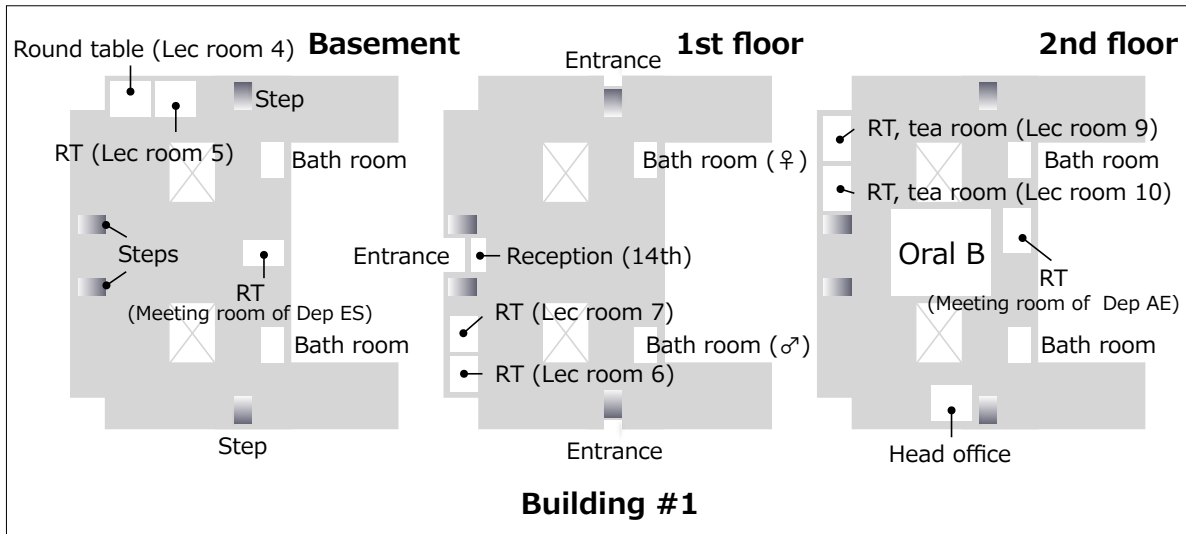

**Campus of Agriculture and Life Sciences**

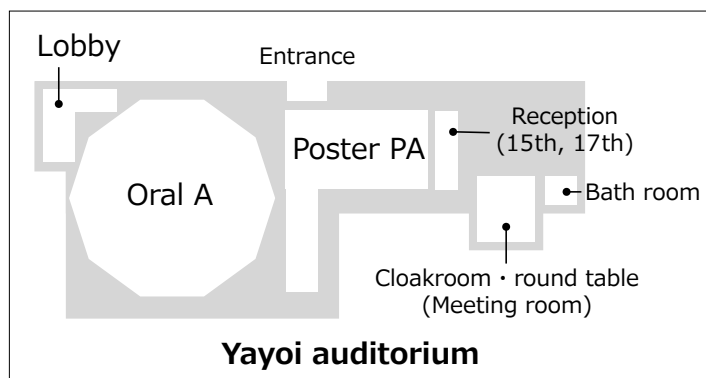
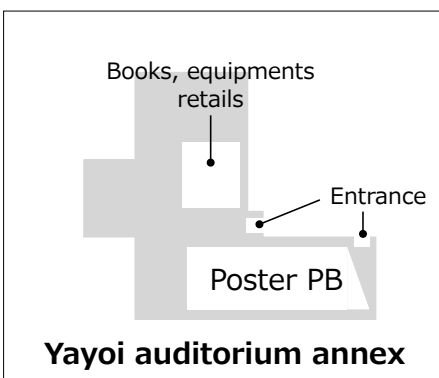

# Access map

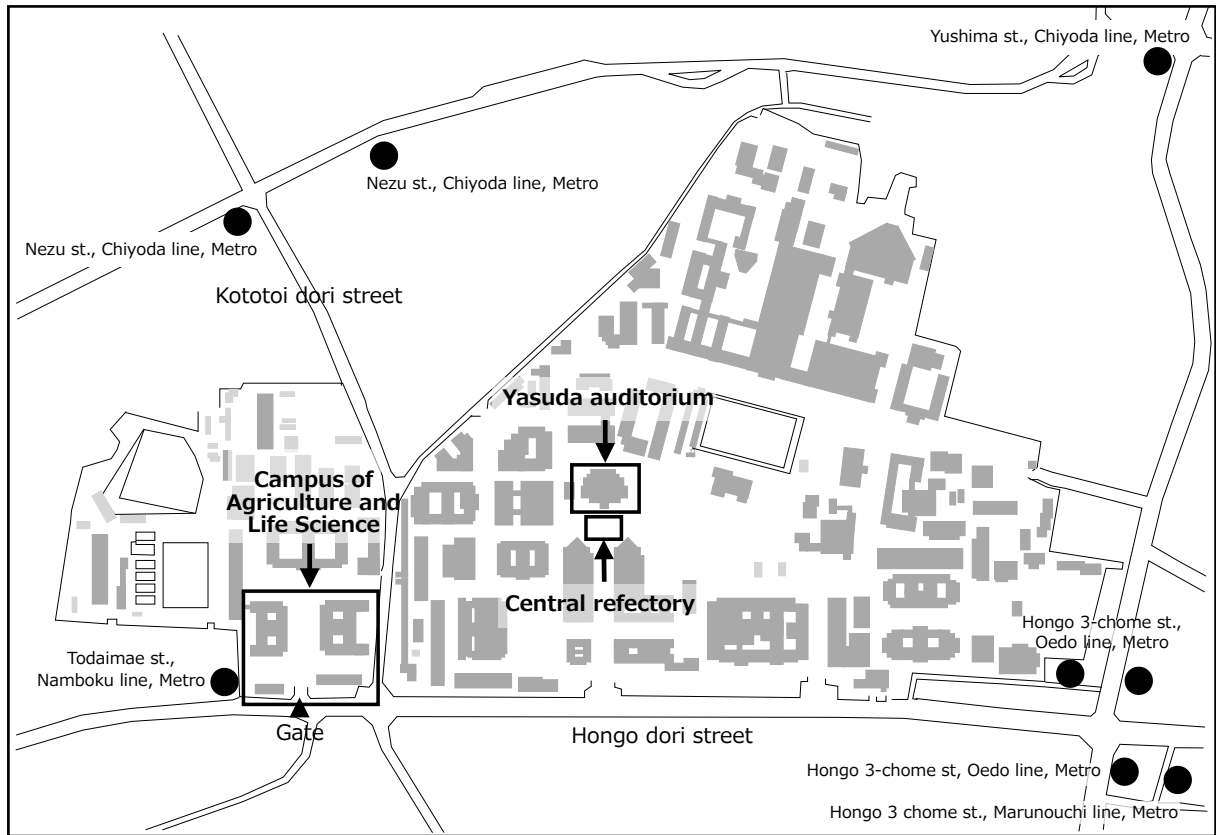

# **The Celebration of the 100th Anniversary of Ornithological Society of Japan**

Sunday, 16 September, 2012  
Yasuda Auditorium, University of Tokyo

## **Program**

### **Celebration of the 100th anniversary**

- 10:00 Opening: Dr Isao Nishiumi, Vice President of OSJ
- 10:01 Address by President of OSJ, Prof Dr Yasuo Ezaki
- 10:15 Congratulation by Guests from Ministry of Environment and Agency for Cultural Affairs
- 10:25 Congratulation by Prof Dr Franz Bairlein, President of IOU
- 10:30 Introduction of guests and congratulation messages : Dr Isao Nishiumi
- 10:35 “The History of Ornithological Society of Japan in this 100 years” by Prof Dr Hiroshi Nakamura
- 11:30 Closing : Dr Isao Nishiumi

### **Special Lecture** 13:00 -14:25

#### **Current perspectives in the study of bird migrations**

Franz Bairlein, Institut für Vogelforschung "Vogelwarte Helgoland",  
President of IOU (Germany)

#### **Evolutionary genomics of host-pathogen interactions: House Finches and Mycoplasma**

Scott Edwards, Harvard University, Past-Chair of SPC (USA)

Coordinated by Keisuke Ueda (2014 IOCongress-Convener)

### **Symposium “Phylogeography of Birds in East Asia”** 14:40-17:40

#### **Process of avian endemism revealed by phylogeographical approach and Ecological Niche Model: China avian endemism case report**

Lei Fumin (Key Laboratory of Zoological Systematics and Evolution,  
Institute of Zoology, Chinese Academy of Sciences, China)

#### **The Taiwan Connection-- relationship between Taiwan and East Asian birds**

Lucia Liu Severinghaus (Research Center for Biodiversity, Academia  
Sinica, Taiwan) and others

**DNA barcoding and the perspective of researches on species classification in Asia: Japanese Islands may have contributed to the rich species diversity of Asian birds**

Isao Nishiumi (National Museum of Nature and Science, Japan)

**Phylogeographic patterns and microevolution processes in crows and other birds in East Palearctic**

Alexey P. Kryukov (Institute of Biology & Soil Science, Far East Branch  
Russian Academy of Sciences, Russia)

**General Discussion**

Coordinated by Hiroyoshi Higuchi (Keio University SFC)

## Oral session A, September 15

9:00	A1	Distribution of feeding sites of Baikal Teals ( <i>Anas formosa</i> ) wintering in Katano-Kamoike, Ishikawa Pref.	○SAKURAI Y, TAJIRI H, TAGOME K, NAKANO Y, YAMAMOTO Y, IKEDA T, YAMAMURA Y, OKAMOTO H
9:15	A2	Pattern of paddy-field bird community in Ogura-ike Reclaimed Land, Kyoto Prefecture	○NAKAGAWA Y, EZAKI Y
9:30	A3	Long-billed ringed plover is resident bird or not? Ecology of the bird in the non-breeding season ,at along a river of the central part of Saitama prefecture in Japan	UCHIDA H
9:45	A4	The change of sites of colonies of <i>Sterna albifrons</i> in Mie Pref. Japan	TAKEDA K
<hr/>			
10:00	A5	Probability of persisting re-introduced population of Japanese Crested Ibis, <i>Nipponia nippon</i> , for 50 years on Sado Island	○NAGATA H, YAMAGISHI S
10:15	A6	An attempt to examine foraging site use of Crested Ibises released on Sado, from their behaviors	○NAKATSU H, NAGATA H, YAMAGISHI S
10:30	A7	Nest site selection of Crested Ibis in Sado island; integrate local and regional-scale approach	○UENO Y, KANEKO Y, NAKATSU H, NAGATA H, YAMAGISHI S
10:45	A8	Feather mite fauna found in Crested Ibis ( <i>Nipponia nippon</i> ) populations of Japan and China	○KUROKI T, AGAHORI M, SHIMANO S
<hr/>			
Break (11:00 - 11:10)			
<hr/>			
11:10	A9	Productivity of Osprey in Himi, central Japan	NOGUCHI M, DOI Y, ○ANADA S
11:25	A10	On the conservation of Peregrine Falcons ( <i>Falco peregrinus</i> )	○HIGASHI C, MATSUO Y
11:40	A11	How female Goshawk respond to an accidental death or disappearance of male just before the breeding season?	○OHORI S, UCHIDA H
11:55	A12	Short term behavioral response of nestling Blakiston's Fish Owls to handling disturbance	HAYASHI Y
<hr/>			
Break, Poster Session (12:10 - 15:20)			
<hr/>			
15:20	A13	Cases of control of invasive alien bird species in Japan	○SATO S, ISHIDA K, EGUCHI K, KAWAKAMI K, KATO Y
15:35	A14	The first record of cuckoo brood-parasitism on introduced Red-billed Leiothrix	○TOJO H, NAKAMURA S
15:50	A15	Change in the distribution of seabird breeding wild-goats after eradication in muko-jima islands (Bonin Islands)	○SUZUKI H, HORIKOSHI K, SASAKI T, INABA M
16:05	A16	Comparison of nest height of Jaspnese Bush Warblers on Miyake Island before and after introduction of Japanese Weasels	○HAMAO S, HIGUCHI H
<hr/>			
Break (16:20 - 16:30)			
<hr/>			
16:30	A17	Foraging ecology of the Black-faced Spoonbills in the Yatsushiro Sea	○TAKANO S, HENMI Y
16:45	A18	Effects of the 2011 Tohoku earthquake and tsunami on the distribution of Brent Geese	○SHIMADA T, KURECHI M, SUZUKI Y, MIYABAYASHI Y, HIGUCHI H
17:00	A19	How did the Tohoku earthquake and Tsunami influence the Japanese marsh warbler?	○TAKAHASHI M, TSUMAGARI T, EBINA J, MIYA A, MUGISAWA T
17:15	A20	Radioactive contamination of the Barn Swallow's nests in Japan	○IWAMI Y, KOBAYASHI S, SHIBATA Y, YAMASAKI S, OZAKI K

## Oral session B, September 15

9:00	B1	The diversity of skull form in Japanese pet-type domestic chicken	○KUDO K, OGAWA H, ENDO H
9:15	B2	Distinction between volancy and flightlessness in fossil anatids based on skeletal measurement	WATANABE J
9:30	B3	Tail feather abnormalities observed in Reed Buntings in 2011-2012	○OZAKI K, NAKAMURAN, TOMITAN
9:45	B4	The geographical relevances of vocal, DNA, and size in Ural Owls	○MORI M, NISHIUMI I, HIGUCHI A, TAKAGI M
10:00	B5	An application of Great Cormorants for science education in junior high school	○ENDO N, KOBORI S, TAKEMURA M
10:15	B6	Validation of hatching inhibition effects of dry ice on Great Cormorants	○FUJITA T, YAMAMOTO M
10:30	B7	Inter-colonial and annual differences in food habits of Great Cormorants chick-rearing at the Chubu area in Japan	TSUCHIYA K, ○NIIZUMA Y, KAZAMA K, INOUE Y, FUJII H
10:45	B8	Effects of food and its temporal congregation during the egg-laying and brooding period on the start of egg-laying in Great Cormorants ( <i>Phalacrocorax carbo</i> )	○INOUE Y, FUJII H, KUROKI H, TSUCHIYA Y, WATANUKI Y
Break (11:00 - 11:10)			
11:10	B9	Population and breeding records of Ancient Murrelet <i>Synthliboramphus antiquus</i> on Teuri Island, Hokkaido	○HASEBE M, OTSUKI K
11:25	B10	Migration and wintering ecology of rhinoceros auklets	TAKAHASHI A, ○ITO M, SUZUKI Y, WATANUKI Y, YAMAMOTO T, IIDA T, TRATHAN P, NIIZUMA Y, KUWAE T
11:40	B11	Diving behavior and foraging success in European shags: effects of bird age and foraging habitats	○WATANUKI Y, SATO K, SHIOMI K, WANLESS S, DAUNT F
11:55	B12	Foraging strategy of Streaked Shearwaters <i>Calonectris leucomelas</i> : according to annual change of food resources	○ASAHI K, FUJII K, YAMAMOTO M, YAMAMOTO T, MATSUMOTO S, WATANUKI Y
Break, Poster Session (12:10 - 15:20)			
15:20	B13	Consistencies in migratory behaviour of Streaked Shearwaters	○YAMAMOTO T, TAKAHASHI A, SATO T, OKA N, YAMAMOTO M, TRATHAN P
15:35	B14	Clarifying the migratory behavior, migration routes and the wintering sites of Broad-Billed Rollers ( <i>Eurystomus orientalis</i> ) by geolocators	○IIDA T, NAKAMURAN
15:50	B15	Sexual dimorphism according to morphological features and behavior in the doller bird, <i>Eurystomus orientalis</i>	○YAMADA A, KURODA S, KIMURA Y, SAKAMOTO A, GOUDA N, SAIGUSAM
16:05	B16	Vocal communication and behavioral patterns of Broad-billed Rollers ( <i>Eurystomus orientalis</i> ) in breeding season	○GODA N, KURODA S, YAMADA A, SAIGUSAM
Break (16:20 - 16:30)			
16:30	B17	The possibility of molt sequence polymorphism in Japanese Sparrowhawk	○ISEKI F, SATO T, MIKAMI K, KATAOKA N, KAJITAM
16:45	B18	Effect of pre-breeding moult on arrival condition of the Narcissus Flycatcher <i>Ficedula narcissi</i>	○OKAHISA Y, MORIMOTO G, TAKAGI K, UEDA K
17:00	B19	Molting and body coloration of the Crossbill <i>Loxia curvirostra</i> in Aomori Prefecture, Japan	EBINA J, ○MIKAMI K
17:15	B20	Breeding habits of Fan-tailed Warbler observed near Fukushima-gata lagoon, with a special reference to the main food item and its nutriment	CHIBA A



**Oral session A, September 17**

10:00	A21	Mapping risk of bird collision to wind turbines in relation to bird sensitivities to wind farms	○KITAMURA W, TAKEUCHI T
10:15	A22	On analyzing methods for habitat evaluation of grassland birds	○IMAI Y, KUWABARA K, MINOWA Y, YONEBAYASHI C.
10:30	A23	Bird declines due to landscape changes of floodplain after a dam construction: Spatio-temporal comparison based on population estimate	○YABUHARA Y, YAMAMURA Y, AKASAKA T, NAKAMURA F
10:45	A24	Effects of landscape heterogeneity and climatic factors on avian diversity patterns in Japan	○KATAYAMA N, AMANO T, YAMAKITA T, KOMATSU I, TAKAGAWA S, UETA M, MIYASHITA T
Break (11:00 - 11:10)			
11:10	A25	Early Successes of Translocation and Hand-Rearing of Endangered Albatrosses for Species Conservation and Island Restoration	○DEGUCHI T, SURYAN R, OZAKI K, JACOBS J, SATO F, NAKAMURA N, BALOGH G
11:25	A26	The Pacific is Big. Does Bryan's Shearwater Lurk Around the Corner?	○KAWAKAMI K, SUZUKI H, HORIKOSHI K, CHIBA H, EDA M, HIRATA H
11:40	A27	Demographic studies of Rock Ptarmigan by individual marking in Mt.Norikura	○KOBAYASHI A, NAKAMURA H
11:55	A28	A comparison of methods for counting seabirds at sea on the south of <i>Nemuro peninsula</i>	○URA T, FUKUDA Y
Break, Poster Session (12:10 - 15:20)			
15:20	A29	Nest site characteristics of the Okinawa woodpecker in secondary forest:consequences of land-use history pine wilt disease and recent intrusion of <i>Plagiosterna formosana</i>	○KOTAKA N, ABES, SAITO K
15:35	A30	Breeding cases of Okinawa Rails ( <i>Gallirallus okinawae</i> ) in the southern limit of distribution	○KINJO M, NAGAMINE T, NAKACHI M, NAKAYA Y, ETO N, TAMANAHA S, YAMAGUCHI S, KIKUTA I
15:50	A31	Change in habitat use along breeding stage of the White-breasted Waterhen	○IWASAKI T, IZAWA M
16:05	A32	Habitat structure and survival of Grey-headed Lapwing chicks	○WAKISAKA H, WAKISAKA K, NAKAGAWA M, EZAKI Y
Break (16:20 - 16:30)			
16:30	A33	Habitat and breeding ecology of the Blue Rock Thrush that invaded urban area in western Japan	○TORII N, EZAKI Y
16:45	A34	An ornithologist who is concerned about crows talks about them	MORISHITA E
17:00	A35	Breeding Status of Carrion Crows ( <i>Corvus corone</i> )in Sapporo city.	○TAKENAKA M, NAKAMURA M
17:15	A36	Records of wintering and breeding of Black-billed Magpies ( <i>Pica pica</i> ) in Sapporo and its vicinity	○NAKAMURA M, TAKENAKA M

**Oral session B, September 17**

---

10:00	B21	The observation records and background of the appearance of tame Tree Sparrows	○HIGUCHI H, YAMAGUCHI Y
10:15	B22	Population trends of Tree Sparrows in south-central Hokkaido after the crash of 2006	○KUROSAWA R, O-HIRAY
10:30	B23	Why and where is Eurasian Tree Sparrow <i>Passer montanus</i> declining?	○MIKAMI O, MIKAMI K, MATSUI S, MORIMOTO G, UEDA K
10:45	B24	Sex differences in preference for a mate's call in a monogamous parrot	○EDA-FUJIWARA H, HATA Y, INAMURA M, WATANABE A, SATOH R, MIYAMOTO T
Break (11:00 - 11:10)			
11:10	B25	Intraspecific Variation in <i>Scaevola taccada</i> -Difference in Seed Dispersal Ability by Bird and Sea Drift	○EMURA N, SAKAI M, DENTA Y, ANDO H, ISAGI Y, MIYATA K, UEDA K
11:25	B26	Relationship between body size of varied tits and acorn sizer of <i>Castanopsis sieboldii</i> , a primary food for the tits.	○FUJITA K, FUJITA G, HIGUCHI H
11:40	B27	Geographic variation of the clutch size in the Japanese white-eye	○HORIE S, TAKAGI M
11:55	B28	Environmental factors affecting the vocalization behavior of Oriental Scops Owls ( <i>Otus elegans interpositus</i> )	○NAKAOKA K, INOUE C, HORIE S, TAKAGI M
Break, Poster Session (12:10 - 15:20)			
15:20	B29	The discovery of bird language	SUZUKI T
15:35	B30	Responses of other bird species to the two kinds of alarm calls of Great Tits ( <i>Parus major</i> )	SUZUKI T, ○SUGITA N
15:50	B31	Basic Evaluation of Antenna Characteristics of S Band RF Module for Attaching to Bird	○NAKAJIMA I, KITANO T, INOKUCHI S, OZAKI K
16:05	B32	Basic Evaluation of Propagation Characteristics of S Band RF Module for Attaching to Bird	○KITANO T, NAKAJIMA I, INOKUCHI S, OZAKI K
Break (16:20 - 16:30)			
16:30	B33	An Etymological Study of Loons-Referring to Proposal by Dr. Iijima, First President.	MOMOSE J
16:45	B34	Dialect of crow call in the Japanese Green Pheasant ( <i>Phasianus versicolor</i> )	HAYASHI A
17:00	B35	Lead concentration analysis for the identification of archeological domestic goose bone	○EDA M, KODAMA Y, ISHIMARU E, YONEDA Y

---

## Poster Session PA

Boldface: Poster awards entries

---

PA1	Historical relationship between Japanese crane and society in Japan: The Case of distribution and seasonal migration of cranes in the Edo Period	HISAI A	
<b>PA2</b>	Amount of food consumption of Red-crowned Cranes ( <i>Grus japonensis</i> ) in artificial feeding grounds	ITO K, ARITA S, KATO K	
PA3	A population viability analysis for Tancho in Hokkaido, Japan (ver.2012)	○MASATOMI Y, MASATOMI H, MOMOSE K	
PA4	The number of deaths and mortality factors of the cranes in Izumi	○HARAGUCHI Y, YOSHINO T	
PA5	How long is the interval between flight feather molts of Hooded Cranes ( <i>Grus monacha</i> )?: On a method for estimating the interval by photographing	MASUYAMA Y	
PA6	Duplication of the mitochondrial control region in the related species of black-faced spoonbill ( <i>Platalea minor</i> )	○CHO H, NISHIUMI I, ARAYA K	* Canceled
<b>PA7</b>	Distribution and characteristics of Gray Heron colonies in and around Tokyo	SHIRAI T	
PA8	Juvenile Japanese Night Herons ( <i>Nycticorax nycticorax</i> ) breeding in a heronry: Courtship and pair formation	WATANABE H	
<b>PA9</b>	Nesting ecology of the Yellow Bittern <i>Ixobrychus sinensis</i> in irrigation ponds	SAWARA Y	
PA10	Conservation and restration of intertidal flat ecosystems in light of shorebird feeding ecology	○KUWAE T, MIYOSHI E	
PA11	Estimation of the number of breeding pairs of Kentish plover in Shimane Prefecture	○MORI S, HOSHINO Y, TOYOTA A	
PA12	Parasitic trematode <i>Selfcoelum capellum</i> found from a rescued Eurasian curlew ( <i>Numenius arquata</i> )	○IWAKI T, IWAMI Y, KOBAYASHI S, TSURUMI M	
PA13	Ecology of Amami Woodcocks ( <i>Scolopax mira</i> ): Behavior of marked individuals recorded by automatic photography	ISHIDA K, ○TORIKAI H, KAWAGUCHI H, YAMAMURO K	
<b>PA14</b>	Artificial hatching of the Okinawa rail	○NAKAYA Y, NAGAMINE T, SUGITA H, KINJO M, ETO N, YAMAGUCHI S, TAMANAKA A, FUKUDA M	
<b>PA15</b>	Development of Okinawa Rails ( <i>Gallirallus okinawae</i> ) in captivity	○ETO N, YAMAGUCHI S, TAMANAHA A, NAKAYA Y, NAKACHI M, KINJO M, NAGAMINE T, FUKUDA M	
<b>PA16</b>	On changes in number of wintering geese based on simultaneous waterfowl counts	OHARA M	
<b>PA17</b>	Secular change for 40years in nutrient loading from migratory waterfowl to Lake Izunuma-Uchinuma	○NAKAMURA M, SHIMADA T, YABE T, AIZAKI M	
<b>PA18</b>	Changes in the number of wintering waterfowl in the Izumi Plain, Kyushu	○MIZOGUCHI F, MIYAZAKI Y, HARAGUCHI Y, TAKEUCHI T	
PA19	The breeding status of Canada Goose ( <i>Branta canadensis</i> ) in the area around Mt. Fuji and their future control measures	○KATO Y, SHINODA S, HAYAMA H, ISHI T	
PA20	Satellite tracking of migration routes of Baikal Teal ( <i>Anas formosa</i> ) wintering in Katano-Kamoike, centra Japan	○TAJIRI H, SAKURAI Y, TAGOME K, NAKANO Y, YAMAMOTO Y, IKEDA T, YAMAMURA Y, OKAMOTO H	
<b>PA21</b>	Colonial nesting of the Great Crested Grebe Podiceps cristatus	○NKAHAMAS, SAWARA Y	
PA22	Why do the populations of the Pacific Diver in Hiroshima prefecture decrease	○FUJII K, FUJII T	

---

## Poster Session PA

Boldface: Poster awards entries

---

PA23	Food habits of Coots in Lake Biwa analyzed by stable isotope	○HASHIMOTO H, SUGAWA H, UEDA J
<b>PA24</b>	Morphology of syrinx of ducks	OGISO C
PA25	Bird community at northern Abukuma mountains	ISHIDA K
PA26	Effects of the East Japan Earthquake (2011) on the waterfowl population of the Pacific side of the Tohoku district	HIRAIZUMI H
PA27	Prediction of radiation exposure of Streaked Shearwaters by Fukushima nuclear reactors, based on their foraging flights	OKA N
<b>PA28</b>	Bird status in the Gamo Tidal Flat after the East Japan Earthquake (2011)	○SABANO Y, UEMURA S, NAKAJIMA J
<b>PA29</b>	Oil contamination of loons (genus <i>Gavia</i> ) on the Tsushima Islands, Nagasaki	○UEMATSU K, WATANABE H, YAMAMOTO H, UEMATSU A, SADAMITSU T, NISHI T
<b>PA30</b>	Bird strikes on windows observed in Amami Oshima island	○MIZUTA T, ABE Y
PA31	Does construction of a deer-proof fence contribute to recovery of bird communities?	○OKUDA K, KOGANEZAWA M
PA32	Current status of the Red-billed Leiothrix in north-facing slope of Mt. Fuji	NISHI N
PA33	Prey condition of Lidth's Jay breeding in early spring	○TANI T, ISHIDA K, MORI Y, TAKASHI M
<b>PA34</b>	Begging by female Bull-headed shrikes:evaluating the ability of males to feed their offspring	○ENDO S, SUZUKI T
<b>PA35</b>	Is the Bull-headed Shrike ( <i>Lanius bucephalus</i> ) an expert mimic?	○NISHIDA Y, KURODA H, TAKAGI M
<b>PA36</b>	Song as a pre-elicited response?The vocal alarm signals in the Chinese Hwamei <i>Garrulax canorus</i>	MIYAZAWA E
PA37	The Great Tits within a breeding territory of a Japanese Lesser Sparrowhawk are frightened easily by a glimpse of mid-large birds	UETA M
PA38	Comparison of courtship display behaviour between green and Indian peafowl	TAKAHASHI M
<b>PA39</b>	Is it possible to detect of migratory route in passerine species by using trace element analysis of the feathers?	○BAN Y, EBINA J, SAKUYAMA M, MIKAMI K, AZUMA N
<b>PA40</b>	Estimating the origin of exotic Black-billed Magpies ( <i>Pica pica</i> ) in Hokkaido using microsatellite DNA markers	○MORI S, HASEGAWA O, EGUCHI K, HAYASHI Y, KRYUKOV A, NISHIUMI I
PA41	Genetic analysis of Oriental White Stork using microsatellite markers	○NAITO K, NISHIUMI I, OHSAKO Y
<b>PA42</b>	Phylogenetic Relationships of Strigidae,Accipitridae, Falconidae and Caprimulgidae in Korea using COI gene variations	○JIN S.D., PAIK I.H., YU J.P., PAEK W.K., LEE H.S., SEO D.W., LEE J.H.
<b>PA43</b>	An application of DNA barcoding technique in detection of food plants for endangered Red-headed wood pigeons	○ANDO H, SUZUKI S, HORIKOSHI K, SUZUKI H, UMEHARA S,MURAYAMA M, IZAGI Y
PA44	Long-term population trends of migratory Reed Buntings in Japan	○TOMITA N, MORIMOTO G, YOSHIYASU K, OZAKI K

---

**Poster Session PA**

Boldface: Poster awards entries

- 
- |             |  |  |
|-------------|--|--|
| PA45        | Positioning accuracy evaluation of GPS-TX for birds and animals  | ○YAZAWA M, TOKITA K, TAKAHASHI H, AZUMA A, MAESHIIMA M, SEGAWA N, TAMAKI H |
| PA46        | Effective setting of fishing lines to prevent crows from orchards  | ○YOSHIDA H, SAEKI M, MOMOSE H  |
| <b>PA47</b> | Design of cage for protection nests of ground-nesting birds from predation by crows                                      | ○HOSHITANI Y, MATSUMURA M, SATO T, NUKA T, KOBORI H, KITAMURA W            |
| PA48        | Tracking of Jungle Crows using GPS-TX  | ○AZUMA A, SEGAWA N, TAKAHASHI H, NISHI C, TOKITA K, YAZAWA M, TAMAKI H     |
| <b>PA49</b> | Use of farmlands by Jungle Crow subspecies ( <i>Corvus macrorhynchos connectens</i> ) in Okinawa Island, Okinawa         | ○SAITO H   |
| PA50        | Bower orientation in the Great Bowerbirds  | ○EGUCHI K, KATSUNO Y   |
| PA51        | On the practicality of the structure analysis of feather barbules of Japanese birds as a means of species identification | ○FUJII T   |
| <b>PA52</b> | Plumage color comparison between two subspecies of Ruddy Kingfisher ( <i>Halcyon coromanda</i> )                         | ○SUMITA M, MORIMOTO G  |
| PA53        | Breeding territory characteristics of <i>Parus spp.</i> in a urban area, the Republic of Korea                           | Sung Jin PARK, Se Young PARK, ○Woo-Shin LEE                                |
-

## Poster session PB

Boldface: Poster awards entries

---

PB1	Call of Japanese murrelet on the Breeding Islands (Birou Is. and Kou Is.)	○HASHIGUCHI D, FUJII T, FUJII K
<b>PB2</b>	Confirmation of breeding of the Japanese Murrelet in Mimianajima Island, Mie Prefecture - a preliminary survey for elucidation of population genetic structure	○ODAYA Y, HORIUCHI H, HONDA M
PB3	Relation of drifting seaweed to distribution of Japanese Murrelet in the Western Seto Inland Sea -2nd Report-	○FUJII T, FUJII K, HASHIGUCHI D, SUZUKI A
PB4	An Offshore Distribution of Japanese Murrelets in the Pacific Ocean around Eastern Hokkaido	○CHISHIMA J, KATAOKA Y, OSA Y, AOKI N, KUBO S, SASAMORI K
PB5	Surveys of Japanese Murrelets ( <i>Synthliboramphus wumizusume</i> ) at Birojima, Japan, 2011-2012	○WHITWORTH DL, CARTER HR, NAKAMURA Y, TAKESHI M, SATO S, OTSUKI K
PB6	Predicting at-sea distribution of the Japanese Murrelet and its application for the identification of marine IBAS (important Bird areas)	○YAMAMOTO Y, SATO M, NAKAMURA Y, SATO H, ANDO Y, EZAKI I, MILLER M, TAYLOR P, LASCELLES B, MORI S, HAYAMA S, KOBAYASHI Y
<b>PB7</b>	Effects of incubation behaviour and shells on controlling temperature in the Little tern nest	○NUKA T, KAWAKUBO M, GEMMA Y, KOBORI H, KITAMURA W
<b>PB8</b>	Movements and activities in post-breeding season and sabbatical year of male Blacktailed Gulls	○KAZAMA K, HIRATA K, YAMAMOTO T, HASHIMOTO H, TAKAHASHI A, NIIZUMA Y, TRATHAN PN, WATANUKI Y
PB9	Locate the breeding grounds of Herring Gulls ( <i>Larus argentatus</i> ): (1) Findings in wintering grounds	○SATO T, NONAGASE M, YAMAGUCHI M, KAWAGUCHI Y, SUZUKI Y, IWASAKI K, YAMAMOTO N, HORIE S
<b>PB10</b>	Assimilation efficiency and growth of Rhinoceros Auklets fed by Sand Lance and Pacific Krill	○KUME Y, NIIZUMA Y, KAZAMA K, ITO M, YAMASHITA R, WATANUKI Y
<b>PB11</b>	Observation records of Rhinoceros Auklets ( <i>Cerorhinca monocerata</i> ) in the Inland Sea of Japan	○WATANABE H, YAMAMOTO H, IWASAKI O, TAKEMOTO A, KURODA Y, UEMATSU M, UEMATSU A, MORI C, UEMATSU K
<b>PB12</b>	Breeding pairs of Spectacled Guillemot <i>Cepphus carbo</i> on Teuri Island and a suggestion of the direction of their foraging area	○SENZAKI M, HASEBE M
PB13	Distribution of common cormorant colony and roost in Japan (III)	KATO N
<b>PB14</b>	Distribution of Common Cormorant and Japanese Cormorant in coastal Chiba Prefecture and the lower Tone River	○MINOWA Y, KUWABARA K
<b>PB15</b>	Breeding seasons of Great Cormorants in Japan: Why do they breed in autumn in the Kanto region ?	○OKUDA Y, OKUDA Y
<b>PB16</b>	Three-dimensional image analyses on the movable range of toe skeleton in owl ( <i>Strix uralensis</i> )	○SUZUKI M, SASAKI M, YAMADA K, DAN M, ONO K, YANAGAWA H, OSHIDA T, KITAMURA N
PB17	Individual identification and its development of Blakiston's Fish Owls ( <i>Ketupa blakistoni</i> ) by DNA markers: Importance of long-term sampling and its preservation	○TAKENAKA T, OMOTE K, NISHIDA C, MASUDA R
<b>PB18</b>	Neighbour-stranger discrimination in Daito Scops Owl	○INOUE C, NAKAOKA K, TAKAGI M
PB19	Home Range of Eurasian Eagle Owl in Korea for Spring Season	○KIM S.H., KANG S.G., KANG T.H., KIM D.H., LEE H.S., HUR W.H., KIM J.H., HAN S.H.
<b>PB20</b>	Temporal Changes of Genetic Diversity and Population Structure in the Endangered Blakiston's Fish Owl	○OMOTE K, NISHIDA C, TAKENAKA T, SAITOU K, SHIMURA Y, MASUDA R
<b>PB21</b>	The diet composition of the Gray-faced Buzzard nestlings and its local difference between Iwate and Fukuoka	○KAMIMIZU A, AZUMA A, ITAYA H, SUZUKI A, KANEKO K, ISEKI F
PB22	Prey items of Gray-faced Buzzards ( <i>Butastur indicus</i> ) breeding in hilly areas	○IMAMORI T, NONAKA J, MASUKAWA K, HORITA M, HORITA N, SAGAWA T

---

## Poster Session PB

Boldface: Poster awards entries

---

<b>PB23</b>	When do raptors bring coniferous leaves to their nest?	○SAKAI S, YASUDA M, MOMOSE H, HIGUCHI H
<b>PB24</b>	Genetic diversity and population structural analysis of <i>butastur indicus</i> based on mtDNA	○NAGAI K, AZUMA A
PB25	Nesting forest stand age by using three raptor species in the Tokachi Plain, Hokkaido	○HIRAI K, YANAGAWA H
<b>PB26</b>	Home Range of Cinereous Yulture in Wintering Region in Korea	○LEE S.W., KANG T.H., KIM I.K., KIM D.H., UNO H.J., SHIN Y.U., HAN S.W., KIM S.H.
PB27	Feeding behavior of Golden Eagle nestlings	MAEDA T
PB28	Collisions of White-tailed Eagles with wind turbines in Hokkaido, Japan	○SHIROKI S, INOM
PB29	Breeding monitoring of White-tailed Eagles in Shiretoko peninsula	○NAKAGAWA H, MORI S, ISHII E, WAKUSAKA S, YAMANAKA M, MASUDA Y, TAZAWA M, SHINAZAKA G, SHIRAKI S
<b>PB30</b>	Microhabitat preference and spatial difference in behavior of avian species in and around the Yayoi Campus, the University of Tokyo, Japan	○HASHIMOTO A, KATOH K
PB31	Distribution and abundance of forest Birds in Eastern Hokkaido	TAMADA K
<b>PB32</b>	Bird population trends in urban Tamagawa River	○ISHIE A, YAMANAKA H, OKAHISA Y, HIRAYAMA E, IWASA N, IWAMOTO A, OKAZAKI S, KANDA Y, SETO T, TAKASHINA A, TOGO N, NIKURA N, FUJITSU A, HOSHINO R, KUWABARA K
PB33	Habitat selection of Grey Nightjar <i>Caprimulgus jotaka</i> in a mountainous area of Japan	○KIMOTO S, KATOH K, IMAMORI T
PB34	The status of Jungle Nightjars <i>Caprimulgus indicus</i> in Tochigi Prefecture, central Japan	○HIRANO T, NONAKA J, ISHIHAMA T, TETSUKA I, KAWADA H
PB35	Relationship between distribution of tree creeper <i>Certhia familiaris</i> and snow fall	IWAMOTO J
<b>PB36</b>	Feeding behaviour of <i>Parus varius</i> breeding in an artificial conifer forest of <i>Cryptomeria japonica</i> with small patches of broadleaf trees	○KONDO T, HIJII N
<b>PB37</b>	Fruits choice by Japanese white-eye ( <i>Zosterops japonicus</i> ) on the bird cherry ( <i>Prunus qravana</i> ) showing various berry colors	○TSUJI A, KAWAKUBO N
PB38	Comparison of foraging signs between Black Woodpecker and White-backed Woodpecker	UNNO A
<b>PB39</b>	Breeding ecology of the Wryneck <i>Jinx torquilla</i> in Ogata village	○KATO T, DOBASHI R, MIKAMI K, UEDA K
PB40	A record of Three-toed Woodpecker <i>Picoides tridactylus</i> in Hokkaido, Japan	HASE C, HIEDA K, MOCHIDUKI T, ○ARA T, AZUMA A
<b>PB41</b>	Considering of Based on Japan Integrated Biodiversity data: A case study of the decline of the Tree Sparrow <i>Passer montanus</i>	○MORIMOTO G, MIKAMI O, MIKAMI K, MATSUI S, KASAHARA S, UEDA K
PB42	Does Tree Sparrow's bib size reflect male quality?	○MATSUI S, KASAHARA S, KATO T, IZUMI H, MORIMOTO G, UEDA K, MIKAMI O
PB43	Estimation of average daily food intake in the Tree Sparrow <i>Passer montanus</i>	○YAMAGUCHI Y, MOMOSE H, YOSHIKAWA K
PB44	A Comparison of diet of nestling Tree Sparrows in rural and urban environments	○KASAHARA S, MATSUI S, AZUMA N, YAMAGUCHI Y, MIKAMI O, UEDA K

---

## Poster Session PB

Boldface: Poster awards entries

---

<b>PB45</b>	Behavioral Plasticity of Barn Swallow ( <i>Hirundo rustica</i> ) on climate change	○KOMATSU N, KOBORI H, KITAMURA W
PB46	Contributory factors to breeding distribution of Blue Rock Thrushes ( <i>Monticola solitarius</i> ) expanding into inland	KASUYA K
<b>PB47</b>	Chestnut-cheeked Starlings ( <i>Sturnus philippensis</i> ) molt in Osaka on their migration	○OKUDA Y, OKUDA Y
PB48	Nationwide increase of communal roosts of Gray Starlings ( <i>Sturnus cineraceus</i> ) in cities and its contributory factors	KOSHIKAWA S
PB49	Season transition of the Bulbul distribution in Miura Peninsula	HASHIGUCHI Y
<b>PB50</b>	Breeding biology of <i>Eurystomus orientalis</i> : reproductive performance of 6 years	○KURODA S, MINE K, MARUYAMA K, NAKAMURA H, SAIGUSA M
PB51	Annual and regional differences of nocturnal singing activity in the Asian Stubtail	○KAMIOKI M, UEDA K
PB52	Song alteration and maintenance in adult male Bengalese finches modulated by behavioral context	○WATANABE A, EDA-FUJIWARA H, MIYAMOTO T
<b>PB53</b>	Do hosts of bronze-cuckoos recognize foreign nestlings through learning?	○SATO N, TANAKA K, MIKAMI O, UEDA K
PB54	Distribution of Common Cuckoos ( <i>Cuculus canorus</i> ) in and around the Musashino Plateau	○ITAYA H, MATSUMOTO A, KAWABE K, HARADA Y, ONIKUBO H, ONAKI M, KIMOTO S, NISHIKAWA Y, MASHIKO O, MORIYA T
PB55	Bird species recorded by camera traps and IC recorders on an inhabited island: Gaja-jima, in the Tokara Island	SEKI S
PB56	Development and utilization of bird location systems using electronic waves	○TOKITA K, TAKAHASHI H, YAZAWA M, AZUMA A, MAEJIMA M, SEGAWA N, HIGUCHI H, TAMAKI H
PB57	Highly Pathogenic Avian Influenza (HPAI) on Wild Bird in Japan, 2010-2011	○KANAI Y, NEGAMI Y
PB58	Electrocardiogram records with catheter of upper gastrointestinal tract	○NAKATA K, KITANO T, NAKAJIMA I, KUWAHIRA I, HATA J
PB59	Making of "Morphological note on birds" 2	○KAWAGUCHI S
PB60	On Hyojiro Orii, an early naturalist of Japan	○OHATA K, SETODA K, WASHIDA Y
PB61	On Yanagihara ornithological collection: (2) Collection by Hyojiro Orii	SETSUDA K
PB62	Bird species whose feathers make an appearance in the Japanese Tea Ceremony	SHIMOSAKA T
PB63	Introduction to Minori Ogawa ornithological collection at Meiji period	○KOBAYASHI S, TSURUMI M
PB64	Bird species list of Southern Yamashiro: Status and change of rare birds	○NAKAGAWA M, UENO K, WAKISAKA H, OUE N, TAKEUCHI Y, YAMANAKA J, FUJITAKA N
PB65	OGAWA Minori, a pioneer in Japanese ornithology who died young: His works and collection donated to the Yamashina Institute for Ornithology.	○TSURUMI M, KOBAYASHI S

---



**Poster Session PB**Boldface: Poster awards entries

---

**Section for high school students**

- PB66** Analysis of courtship displays in two cordon-bleu species ○HARADA M, OHTA N, SOMA M
- PB67** An analysis on songs of Arctic warblers (*Phylloscopus borealis xanthodryas*) using sound spectrogram HIRONO T, UEMURA S, YAMANA A, NAKAMURA S
- PB68** Relationship between bull-headed shrikes and Daurian redstarts at their foraging territories during the wintering season IJIMA D
- PB69** Molting of black wood pigeons (*Columba janthina*) in captivity INOUE M, KOIE A, MORISHITA M
- PB70** Changes in avifauna recorded in Botanical Garden of Togakushi for 30 years MIYAZAWA K
- PB71** Foraging ecology of black wood pigeons revealed by analyses of stable isotope ratios SATO T, KONISHI K, FUKATANI R, YOSHIOKA Y
- PB72** Differences in light wavelength affect egg productivities of domestic fowls SUZUKI K, SUZUKI M
- PB73** Bird survey of Mt. Hotaka in 2012 OSHIMA K *et al.*
-

## **The 100th Anniversary Round Table Discussion**

**18:00 - 20:00, September 15**

### **RTD A. Genetic divergence and ecological adaptations on the alpine environment of the Japanese Rock Ptarmigan**

Organizers: A. Kobayashi, H. Nakamura

Meeting room of Department of Agricultural and Environmental Biology, 2nd floor, building #1

### **RTD B. New technology and regional topics for avian phylogeny**

Organizers: T. Saito, S. Seki, T. Hiraoka, I. Nishiumi

Meeting room of Department of Ecosystem Studies, the basement, building #1

### **RTD C. Let's think together about the evolution of morphology and locomotion of birds: Integrating ornithological and paleontological perspectives**

Organizers: M. Eda, Y. Watanuki

Lecture room #9, 2nd floor, building #1

### **RTD D. Involving the public through citizen science to learn about the distributions, timing and natural histories of birds**

Organizers: M. Ueta, R. Kurosawa, K. Koyama

Meeting room, Yayoi auditorium

## **Round Table**

**18:00 - 20:00, September 14**

### **R1. Researches on Anatidae flyway network and their conservation programme**

Organizers: ○H. Sugawa, K. Koyama, S. Moriguchi

Lecture room #1 of Chemistry, 2nd floor, building #2

### **R2. Understanding of distribution and migration of Gavidae**

Organizer: J. Momose

Lecture room #9, 2nd floor, building #1

### **R3. Reconsider the studying life-history strategy!**

Organizers: S. Horie, M. Takagi

Lecture room #10, 2nd floor, building #1

**18:00 - 20:00, September 15**

### **R4. Where do birds go when they go from here? Part 2: Initiatives for understanding bird and animal migration -a new approach to tracking equipment**

Organizers: ○K. Tokita, H. Higuchi, H. Tamaki

Lecture room #4, the basement, building #1

**R5. Impact of offshore wind farms on seabirds**

Organizers: K. Kazama, O. Hasegawa  
Lecture room #5, the basement, building #1

**R6. Invitation to oology: Let's rethink about eggs**

Organizers: K. Tanaka, W. Kitamura  
Lecture room #6, 1st floor, building #1

**R7. Considering coexistence of human and great cormorants. vol. 15:  
The voice**

Organizers: M. Yamamoto, N. Kato  
Lecture room #7, 1st floor, building #1

**R8. Shorebird study: Habitat selection of shorebirds at rice paddy and  
lotus fields**

Organizers: T. Moriya, Y Nishikawa  
Lecture room #10, 2nd floor, building #1

**18:00 - 20:00, September 17**

**R9. Urban bird study: Recent studies and future perspective**

Organizers: H. Kawachi, S. Koshikawa, Y. Shibata  
Lecture room #4, the basement, building #1

**R10. Feeding wild birds (4): Cases of unintentional feeding by humans**

Organizer: K. Hirata  
Lecture room #5, the basement, building #1